

North View | Downtown Skyline

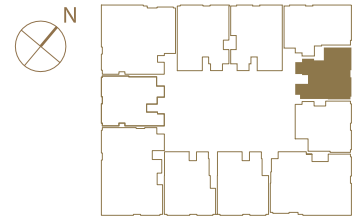

SALES GALLERY | 877 S. Francisco Street, Suite C-6, Los Angeles, CA 90017  
 Sales Gallery Hours | Mon-Sat 10-6, Sun 12-6  
 213.493.5555 | info@metropolislosangeles.com | MetropolisLosAngeles.com



The information contained herein is deemed reliable, but is not guaranteed. Owner makes no representations for variances in units that may include but are not limited to views, exposure to light including any existing or future construction by either Owner or a third party, finishes for the final product as well as items depicted in photography and/or renderings. Floor plans and finishes are subject to change and square footage measurements are approximate and may be based on various measurement methodologies, subject to construction variances and tolerances, and may vary from floor to floor. Pricing is subject to change without notice. No real estate broker or agent is authorized to make any representations or other statements regarding the residences or the project, and no agreements with deposits paid or other arrangements shall bind the developer. Owner reserves the right to make changes in accordance with terms of the Offering Plan and applicable laws and regulations. Obtain the Property Report or its equivalent by Federal and State Law and read it before signing anything. No Federal or State agency has judged the merits or value, if any, of this property. PLANS NOT TO SCALE.

Real Estate Consulting, Sales and Marketing by Polaris Pacific - a licensed California, Arizona, Colorado, Hawaii, Oregon, and Washington Broker. CA DRE #01499250. 02/2020